

MiBOXER[®] | **Mi·Light**
Subordinate New Brand

LED Downlight (Triac dimming)

Installation Diagram

1. Open hole on ceiling (different model have different size of hole, check details in user manual).
2. Please follow diagram to wire light and put back it into the hole of ceiling
3. Make spring stand up and push it into hole, ensure that it spread and fixed on the back of ceiling (picture 3 and 4)

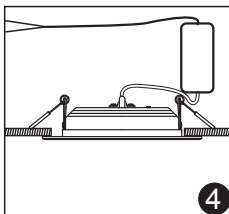
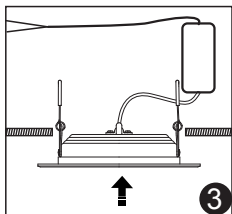
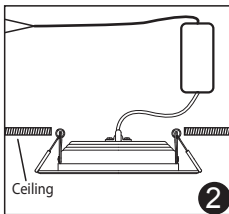
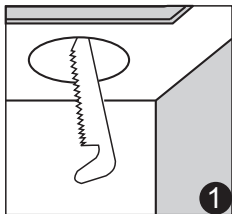
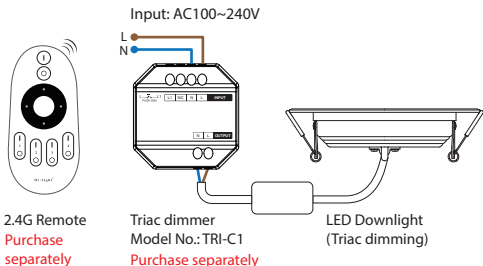



Diagram Connection With Triac Dimmer



 Please ensure that every connection is correct before connecting with power source, otherwise it will damage the light

Attention

1. Turn off power source while connecting light.
2. Ensure that voltage of power supply is same as light.
3. Don't disassemble light if you are not expert.



Made in China