

SMART-IN10 A/Z

RECESSED PROFILE PROFIL WPUSTOWY

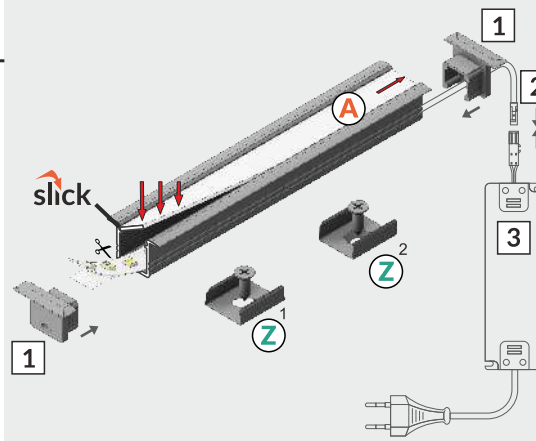
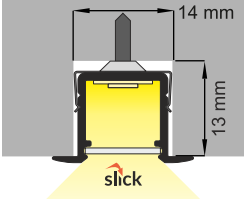
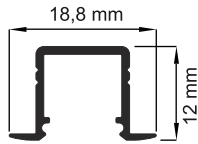

- A** A slide cover klosz A wsuwany
- Z¹** Z flexible mounting plate uchwyt Z sprężysty
- Z²** cone Z flexible mounting plate uchwyt Z sprężysty cone

- 1** SMART-IN10 ending with hole zaślepka SMART-IN10 z otworem
- 2** power supply cable kabel zasilania
- 3** LED power supply zasilacz LED



scissors
nożyczki



pliers
kombinerki



soldering iron
lutownica



solder
cyna



glue
klej

I

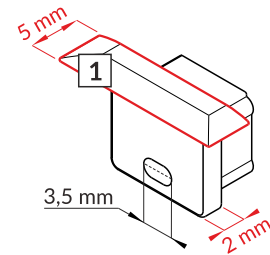
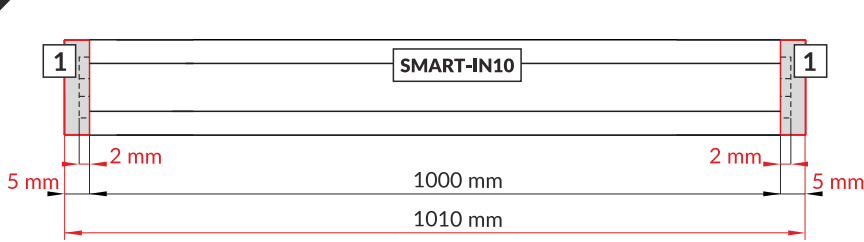

Note! Ending thickness increases the length of the luminaire (+ 2 x 5 mm) and the length of the mounting space (+ 2 x 2 mm).
Uwaga! Grubość zaślepki zwiększa długość oprawy (+ 2 x 5 mm) i długość otworu montażowego (+ 2 x 2 mm).

II

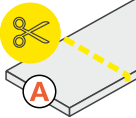

The length of the cover is equal to the length of the profile.
Długość klosza równa jest długości profilu.

III

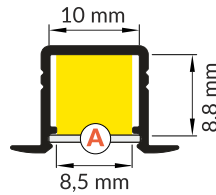
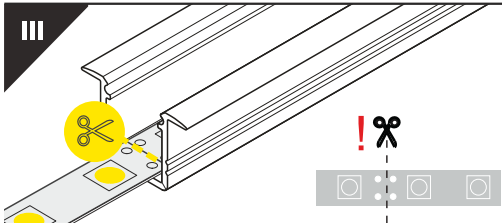

Dimensions of the space to install LED source.
Wymiary przestrzeni do zamontowania źródła LED.

IV

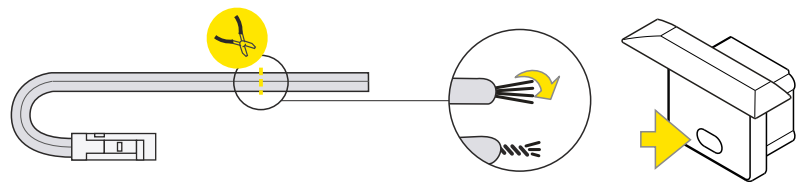
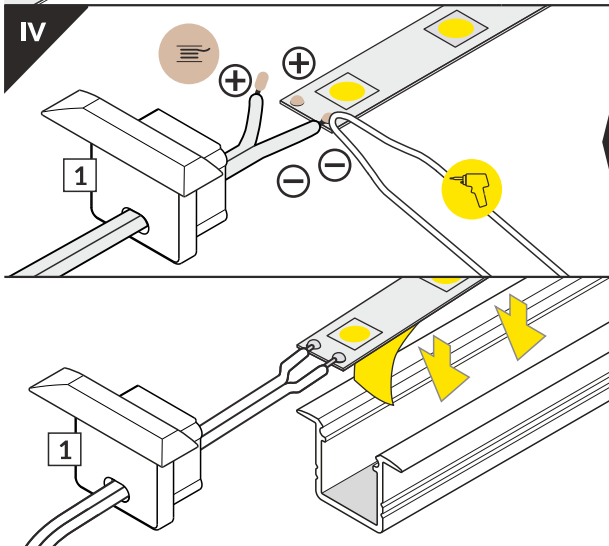

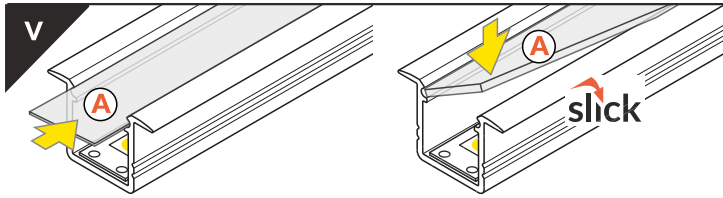

A slide cover / klosz **A** wsuwany

VI MOUNTING / MONTAŻ

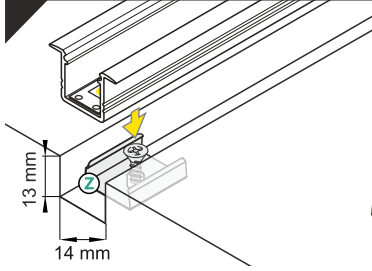

Z flexible mounting plate
uchwyt **Z** sprężysty

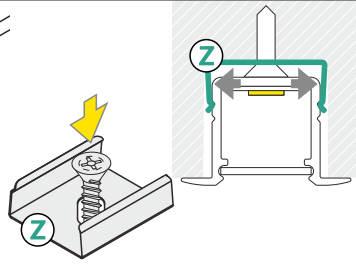

Z flexible mounting plate
uchwyt **Z** sprężysty

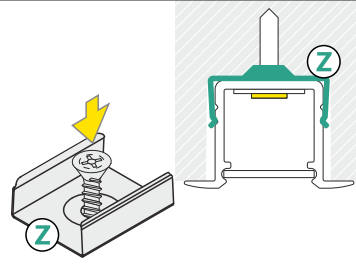

cone **Z** flexible mounting plate
uchwyt **Z** sprężysty cone

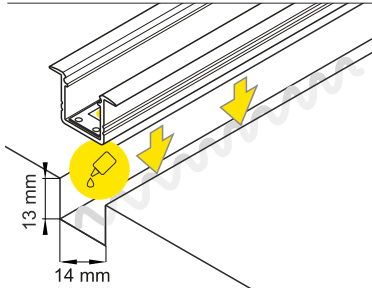

glue
klej montażowy

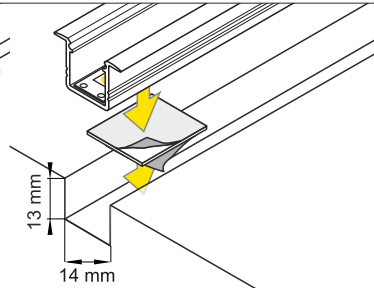

two-sided adhesive tape 25x25
taśma mocująca dwustronna 25x25

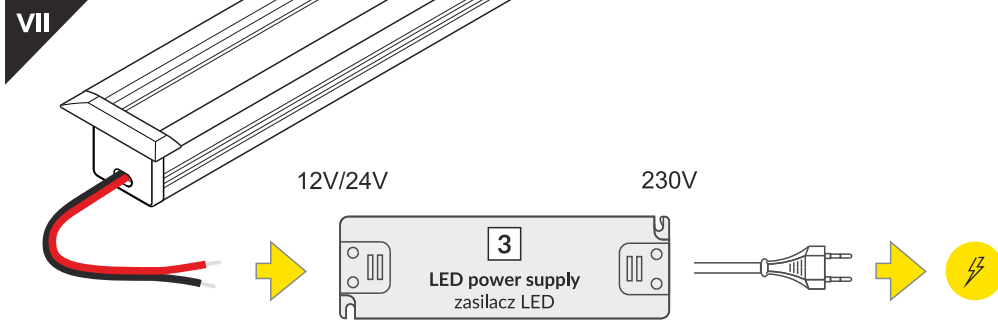

ACCESSORIES / AKCESORIA

- power switches
- controller + remote
- movement sensors
-
- włączniki
- sterownik + pilot
- czujniki ruchu

Check the rest - TOPMET catalogue or www.topmet.co.uk
Zobacz więcej - katalog TOPMET lub www.topmet.pl