

## CCT Knob Remote

Model No.: K5

### Product Feature

- Brightness and color temperature dimmable
- 2.4G wireless transmission technology
- Support Miboxer/Milight 2.4G series
- Control Distance 30m
- 4 scenes storage and control
- Save 4 scenes ( Max 4 scenes)
- Support to work with multi devices



### Product Parameter

Product Name:	CCT Knob Remote	Working temperature:	-10~40°C
Model No.:	K5	EMC standard(EMC):	ETSI EN 301 489-1 V2.2.3 ETSI EN 301 489-3 V2.3.2
Working voltage:	3V(AAA*2PCS)	Security Standard(LVD):	EN 61347-2-11: 2001+A1: 2019 EN 61347-1: 2015+A1:2021 EN 62493:2015+A1:2022
Standby consumption:	20μA	Radio equipment(RED):	ETSI EN 300 400 V2.2.1
Transmission:	6dBm	Certification:	CE、EMC、LVD、RED
Protocol:	2.4GHz RF		
Modulation:	GFSK		
Control Distance:	30M		

### Size



# Function

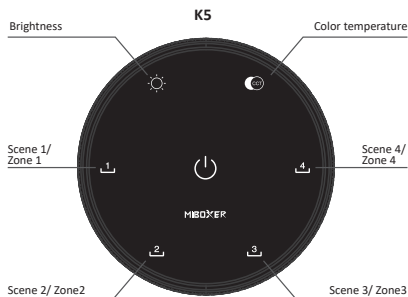

Short press it and rotating the remote to dim brightness, range from 1% to 100%



Short press it and rotating the remote to adjust color temperature, the range from 2700K to 6500K



Turn ON all



1~4 Zone ON



Turn OFF all



1~4 Zone OFF



## Setting CCT :



Press + button 3 seconds simultaneously to enter into mini CCT setting , with a minimum adjustable value of 1800K.



Press + button 3 seconds simultaneously to enter into Max CCT setting , with a minimum adjustable value of 10000K.



Reminding Lo- if it's low battery

## Factory setting: Scene Mode.

### Switching Mode:



4 scenes mode : Press **1** **4** button 3 seconds simultaneously to restart boot animation, it will display SCE while completed



4 Zone ON/OFF mode: Press **2** **3** button 3 seconds simultaneously to restart boot animation, it will display ZON while completed



### Scenes mode **1** ••• **4**

Short press: Activate scene

Long press 3 seconds: Save the current lighting state/  
( the light flashes one time slowly once completed successfully).

### 4 Zone mode **1** ••• **4**

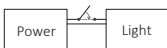

Power off the light or controller for 10 seconds and short press any button from 1-4 six times within three seconds to set up the light in zones

## Link/Unlink

Link controller must link with remote before using it

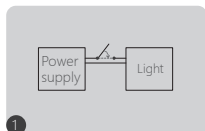

Turn off light 10 seconds and turn on again



Short press "⏻" 6 times within 3 seconds



Link is done once light flashes 3 times slowly



Link is failed if light doesn't flash, please repeat above steps  
(Attention: can not link again if remote already finished linking)

Unlink

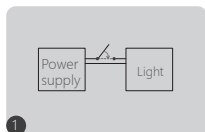

Turn off light 10 seconds and turn on again

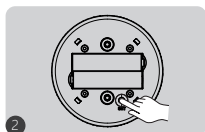

Short press "SET" 5 times within 3 seconds



Link is done once light flashes 10 times quickly



Unlink is failed if light doesn't flash, please repeat above steps  
(Attention: no need to unlink if the light never be linked)

## Installation

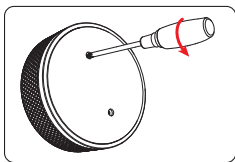

1. Loosen the screws and open the battery cover.



2. Put 3V(AAA\*2) battery into it

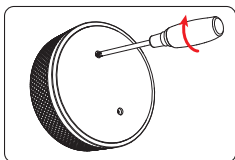

3. Cover it with the battery cover and tighten the screws.

## Attention:

1. To control MiBoxer/Mi-Light 2.4G series products, Please refer to the product manual for compatibility.
2. Don't use it in humidity or high temperature area, please take out battery if don't use it frequently and keep it in dry or static electricity area
3. Don't use it near metal or strong magnetic area, it will affect signal and lost distance.



Made in China